



Features

- Intel® 6th / 7th Generation i7/i5/i3 CPU
- 17" 1280x1024 LCD Panel
- Panel Mounted with Full Flat Touch
- CE, FCC, VCCI Class B Certified
- Support Intel® vPro by CPU
- IP66 Front Easy to Clean
- Wide Range DC Input
- Optional WLAN with External Antenna
- One M.2 / One Mini-PCIe Expansion

Specification

Product		WLP-7F20-17 BKFT	WLP-7F20-17 BKPT
Main System	CPU	6th generation Intel® Core i7/i5/i3 processor 7th generation Intel® Core i7/i5 processor	
	Graphic	Intel® integrated HD Graphics by CPU	
	Memory	Two 2133 MHz DDR4 SODIMM socket support dual Channel, non-ECC, up to 32GB	
	OS Support	Win 7, Win 7 Pro, Win 8, Win 10	
Display	Size	17", 5:4	
	Resolution (pixel)	1280 x 1024 (SXGA)	
	Number of Colors	16.2M colors	
	View Angle (H/V)	170(H) / 160(V)	
	Brightness(cd/m ² , nit)	350 nits	
	Contrast Ratio	1000:1 (Typ)	
Touch Panel	Type	Full flat resistive touch panel	Full flat projected capacitive touch panel
	Light Transmission	80 ± 5%	90 ± 3%
	Hardness	3H	7H
	Lifetime	35M times	100M times
Storage & Expansion	Storage	2.5" SATA HDD drive bay x 1 (with anti-vibration mechanism)	
	Expansion	Mini PCIe x 1, M.2 Type E x 1	
I/O Ports	USB	USB 3.0 x 4	
	COM	2 X RS-232, 1 X RS-232/422/485	
	LAN	2 x RJ-45	
	Audio / Video	3.5mm phone jack connector x 2 (Line-out, Mic-in) / DP x 2	
	Control Keys	Rear bottom: Power on /off	
Power	Power input	DC 9 ~ 32V, DC 12V, optional DC 12 (by DC-DC adapter)	
	Power adapter	External, 100 watts, universal 100 ~240V AC in, 12V DC out, 8.33A	
Environmental	Temperature	Operating Temperature: 0~50°C (12V DC , air flow cooling) Storage Temperature: -20~60°C	
	Humidity	Operating & Storage: 10 ~ 90%, non-condensing	
	Water/Dust resistance	IP66 at front	
Mechanical Characteristics	Housing	Front bezel is Aluminum, others are SECC with black coating	
	Dimensions (Net: mm)	426.2 (H) x 358.6 (V) x 90 (T)	
	Weights (Net: kg)	8.5 kg	
	Mounting	Panel mount, Optional Open frame / Chassis, VESA (75x75)	
Certification	CE/ FCC/ VCCI Class B, Canada ICES-003		

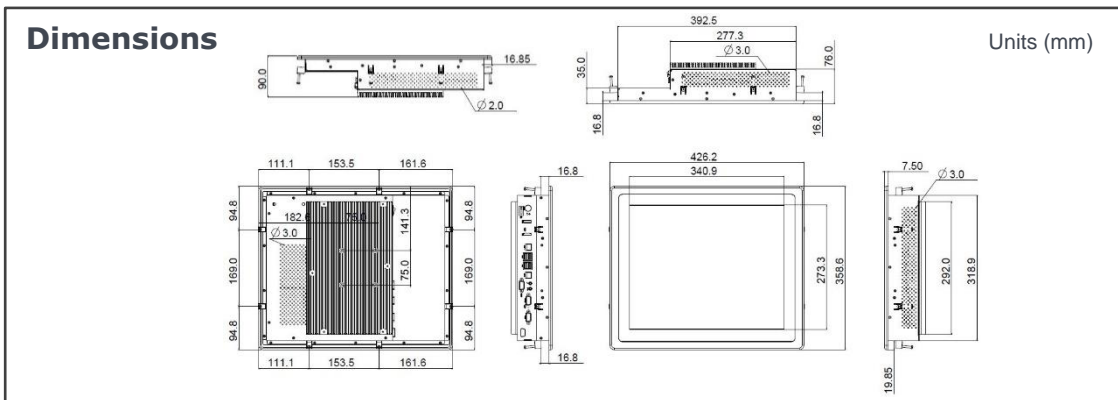

Major Options	
Add On Parts	1. Wireless or Wireless and BT kit 2. 2.5" SSD 3. Stainless steel front bezel 4. Change full flat resistive touch to P-cap touch (BKPT) 5. Silver front bezel 6. Storage door Solution 7. mSATA module 8. TPM 2.0, 9. Chassis type housing
Add On Cable	1. DC input power plug (black, 1.22m length) 2. Maximum length is 5.2 meters by 2x2m DC cables
Customized	1. Open frame housing 2. Sunlight readable optical bonding 3. LCD auto dimming 4. LCD super dimming (Low brightness)

Order Information

Item	Touch	Description
WLP-7F20-17 (i5)	Full Flat Resistive Touch	17" Core i5-6200U/ DDR4 4G RAM/ 500G HDD
WLP-7F20-17 (i5)	Full Flat Resistive Touch	17" Core i5-7200U/ DDR4 4G RAM/ 500G HDD

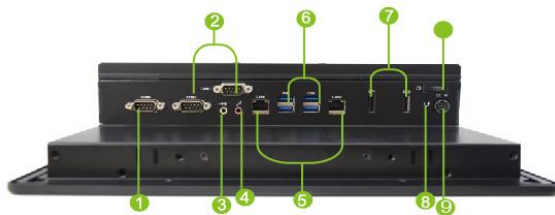

- ① RS232/422/485
- ② RS232 x 2
- ③ Line out
- ④ Microphone-in
- ⑤ LAN x 2
- ⑥ USB 3.0 x 4
- ⑦ DP x 2
- ⑧ Reset
- ⑨ DC-in
- ⑩ Power on/off

