

WLP-7A20-19 V

19" Core i Fanless Industrial Panel PC



○ Main System

CPU	<ul style="list-style-type: none">Intel Core i5-3317U 1.7GHz (dual core, 3MB cache)Intel Core i3-3217U 1.8GHz (dual core, 3MB cache)Intel Celeron 847E 1.1GHz (dual core, 2MB cache)Core i CPU w/ BGA1023 package and 17W TDP
Chipset	Intel® BD82HM65 PCH
Graphics	<ul style="list-style-type: none">Core i5-3317U/i3-3217U: Intel HD Graphics HD 4000Celeron 847E: Intel HD Graphics
Memory	8GB maximum, x 2 DDR3 SODIMM, 1066/1333MHz, 2GB/4GB/8GB
Serial ATA	SATA2 x 2, 300MB/s transfer rate
USB	x 7 (socket), USB 2.0 (x 4 external, x 3 internal)
COM	x 6 (x 2 external, x 4 internal)
Audio	Realtek ALC262 audio codec, 2+2 watts amplifier
LAN	Marvell 88E8071 Gigabit Ethernet x 2
BIOS	<ul style="list-style-type: none">AMI BIOS, 4M EEPROMRTC wake up / Wake on LAN / Power on after power failure / PnP / ACPI

○ LCD Panel

Size	19" 5:4
Resolution (pixel)	SXGA 1280 x 1024
Brightness (cd/m2)	350 nit
Contrast	1000:1
Number of Colors	16.7M (6-bit x 3 + FRC)
View Angle (H/V)	170 (H) / 160 (V)
Response time	5 ms (R + F)
Backlight /life time	LED, 50,000 hours life time

○ Touch Panel

Technology	Resistive touch, 5-wire
Light transmittance	80±3%
Hardness	3H
Touch stylus	No limitation
Resolution	4096 x 4096
Lifetime	36 million activations

○ Key Features

- Fanless industrial panel PC w/ reliable thermal design
- High performance low power Core i CPU & HM65 chipset
- 19" 5:4 SXGA 1280x1024 350 nits LCD w/ LED backlight
- Resistive touch and front IP66 panel mount housing
- Two mini PCIe sockets for WLAN & other add-on expansions
- Robust metal housing and HDD anti-vibration design
- Flexible customization for specific application requests

○ Storage

HDD	2.5" SATA HDD drive bay x 1 + anti-vibration kit, 160GB / 500GB
Expansion slot	Mini PCIe x 2 (52 pin card-edge type)

○ I/O & Control Keys

USB	USB 2.0 x 4
COM	DB-9 x 3 (RS232 x 2, RS232/422/485 <w/ auto flow control>)
LAN	RJ-45 x 2 ,Gigabit
Audio	Line-out, Microphone-in (3.5 mm phone-jack)
Vedio-out	DVI-I x 1
Power input	DC-in x 1, 6V~32V
Control keys	<ul style="list-style-type: none">• Rear bottom: Power on/off, reset• Brightness adjustment through Wincomm's SW utility
LED indicator	Front: Green – power on / Amber – HDD accessing

○ Power

Power adaptor	External, 80 watts, 90~264V AC in, 12V DC out, 1.2m DC cable
Power consumption	65 watts (typical, without any add-ons)

○ Mechanical & Environmental

Housing	<ul style="list-style-type: none">• Standard: Panel mount• Customization: Open frame & chassis
Housing materials	<ul style="list-style-type: none">• SECC metal housing (black color)• Panel mount bezel: Aluminum (black or silver), optional stainless steel
IP rating	IP66 – front side (for panel mount housing)
Cooling	Fanless w/ internal heat sink / pipe & external aluminum fin plate
Mounting Dimension	VESA 75 x 75 / 100 x 100 mm
Weight (net)	495.5 x 384.7 x 90 mm (W x H x D) 9.0 Kg (approximate, w/o power adaptor)
Temperature	<ul style="list-style-type: none">• Operating - 0°C~50°C (w/ air flow) / - 0°C~40°C (no air flow)• Storage – -20°C~60°C
Humidity	Operating & storage – 10%~90%, non-condensing
Regulatory	FCC-A, CE(EMC), VCCI

WLP-7A20-19 V

19" Core i Fanless Industrial Panel PC

Outline Dimension

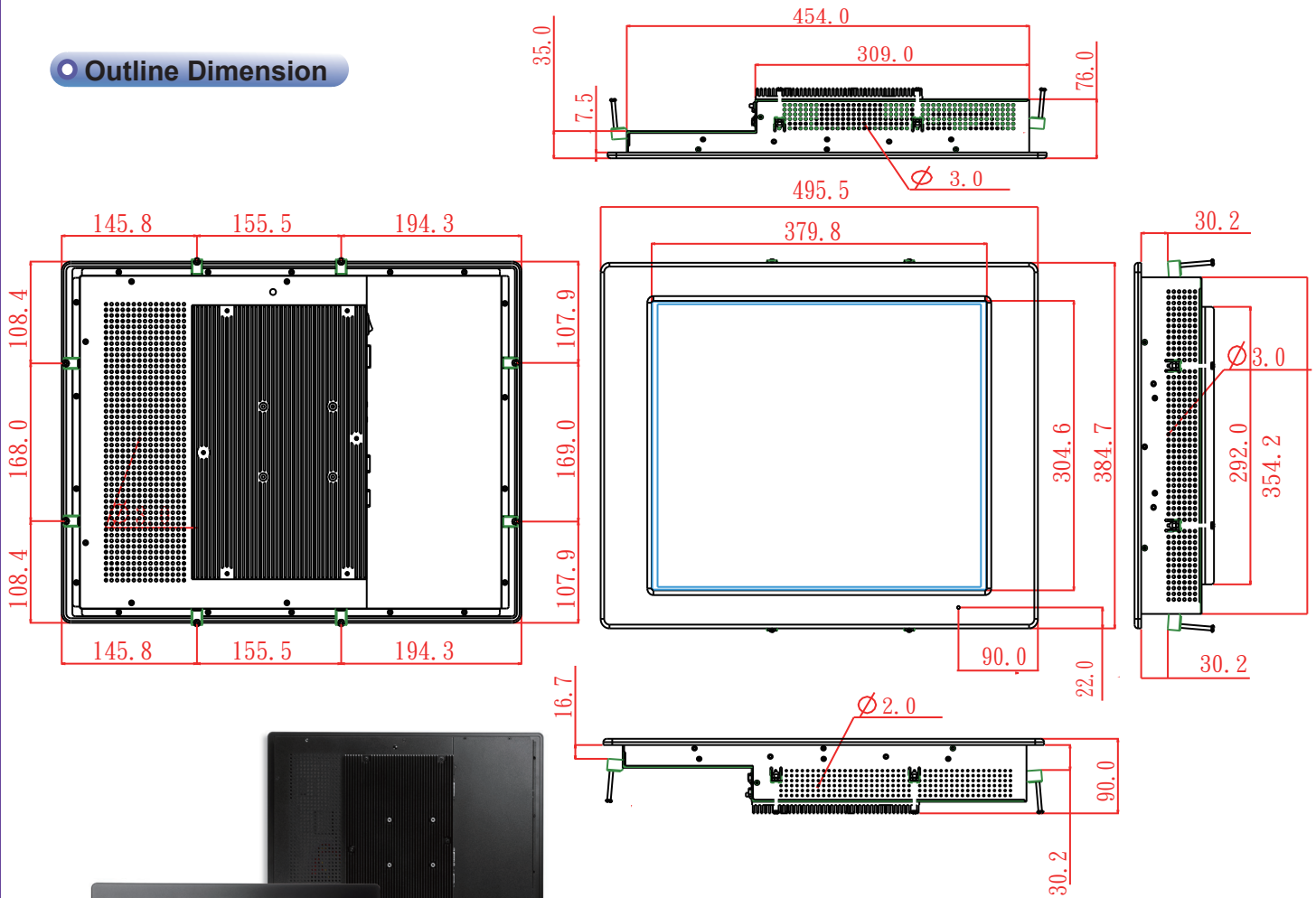

I/O Connectors

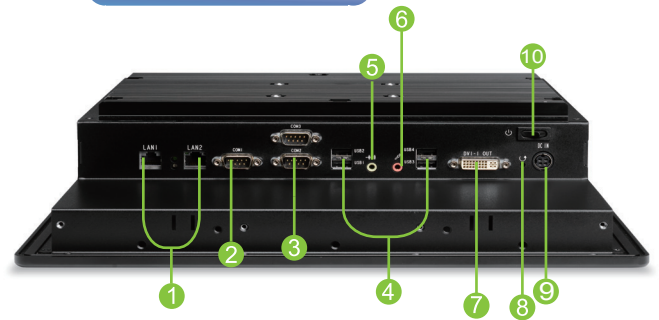

- | | |
|-----------------|-----------------|
| ① LAN x 2 | ⑥ Microphone-in |
| ② RS232/422/485 | ⑦ DVI-I |
| ③ RS232 x 2 | ⑧ Reset |
| ④ USB x 4 | ⑨ DC-in |
| ⑤ Line out | ⑩ Power on/off |

Packaging / Options / Customization

- Packaging** System, power adaptor, AC power cord, CD (drivers & manual)
- Options**
- . WLAN – 802.11 a/b/g/n mini PCIe module w/ external antenna x 1
 - . Stainless steel panel mount bezel
 - . Silver color panel mount bezel
 - . Change resistive touch to capacitive touch
- Customization**
- . Open frame housing
 - . Chassis type housing

Ordering Information

- . CPU: Core i5 1.7G / Core i3 1.8G / Celeron 1.1G
- . Memory: 2G / 4G / 8G
- . HDD: None / 160G / 500G
- . WLAN: None / x 1
- . Panel mount bezel: Black / Silver / Stainless steel
- . Touch: Resistive / Capacitive